

NOTES:

1. DUE TO OUR CONTINUOUS IMPROVEMENT PROGRAM, ALL MODELS AND SPECIFICATIONS ARE SUBJECT TO CHANGE WITHOUT NOTICE.

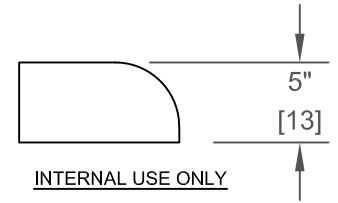
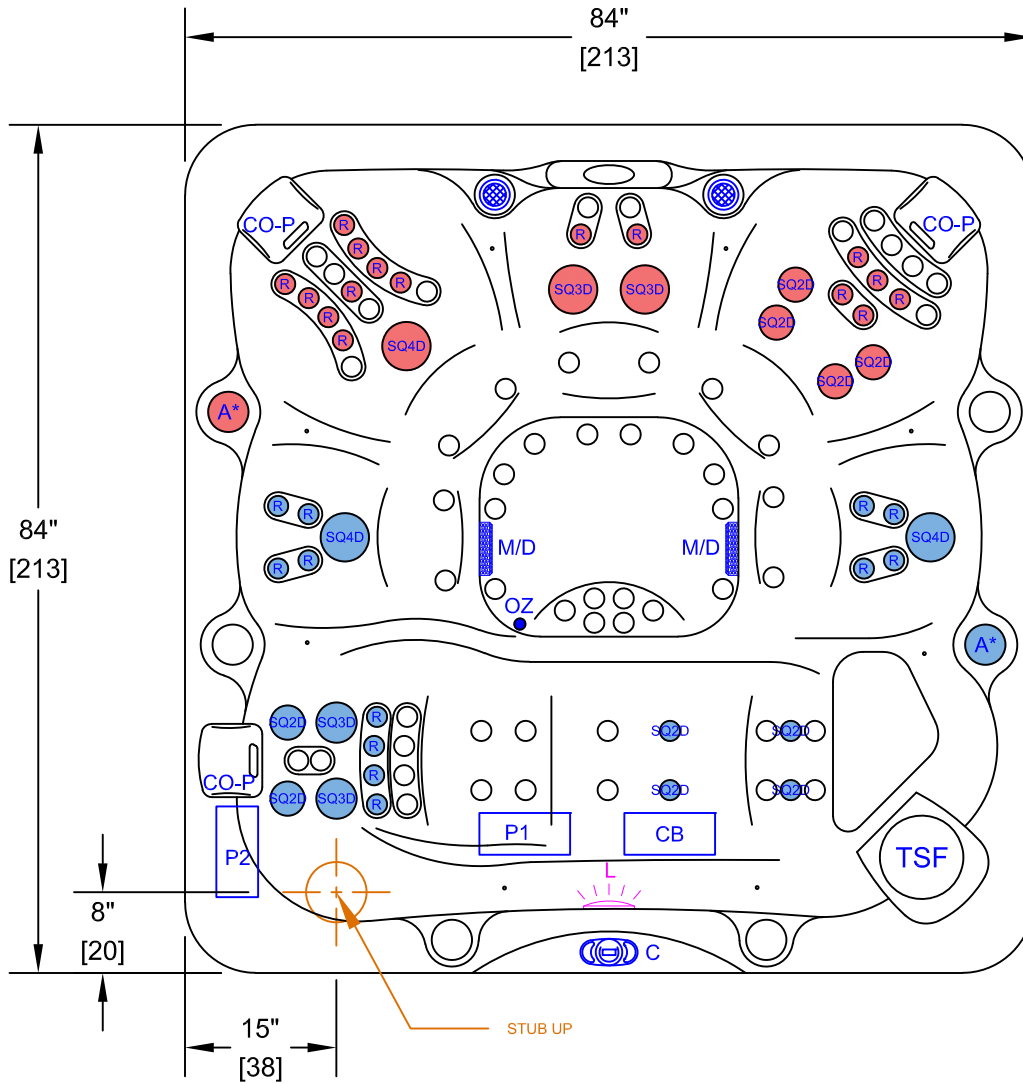

	PUMP 1
	PUMP 2
	PUMP 1
	PUMP 2
	CONTROL BOX

AMZ-745L - LEGEND			
SYMB.	DESCRIPTION	PART NUMBER	QTY.
R	RAIN JET	PLU23028-392-000	28
SQ2D	EURO DIRECTIONAL BLACK	PLU29520-011-500	10
SQ3D	MINI-JET DIRECTIONAL	PLU29530-111-500	4
SQ4D	MAXI FLOW DIRECTIONAL	PLU29540-111-500	3
A*	AIR CONTROL VALVE - STARFIRE		2
TSF	50 SQ. FT. TELEWEIR FILTER (SQR)		1
M/D	MAIN DRAIN		2
CO-P	CO-PILLOWS		3
C	TOPSIDE		1
OZ	HYDRO CLEAR OZONATOR		1
	2.0 SOUND SYSTEM BLUETOOTH 2X3" SPEAKERS		1
L	MULTI COLORED LED LIGHT		1

<small>PROPRIETARY AND CONFIDENTIAL THE INFORMATION CONTAINED IN THIS DRAWING IS THE SOLE PROPERTY OF AMERICAN SPAS. ANY REPRODUCTION IN PART OR AS A WHOLE WITHOUT THE WRITTEN PERMISSION OF AMERICAN SPAS IS PROHIBITED.</small>			
SPECIFICATIONS		TITLE	JET LAYOUT- STD
DIMENSION (in)	84"x84"x36"	LINE	AMERICAN SPAS
DIMENSION (cm)	213x213x91	MODEL	2022 SPA LINE
DRY WEIGHT	900 LBS [363 Kg]	NUM	AMZ-745L
FILLED WEIGHT	4650 LBS [2109 Kg]	DWG NO.	CS002314
		REV	A
WATER CAP.	450 GAL [1703 L]	SCALE	NTS
			SHEET 1 OF 1